

MOVE
20+20/2





MOVE 20/2



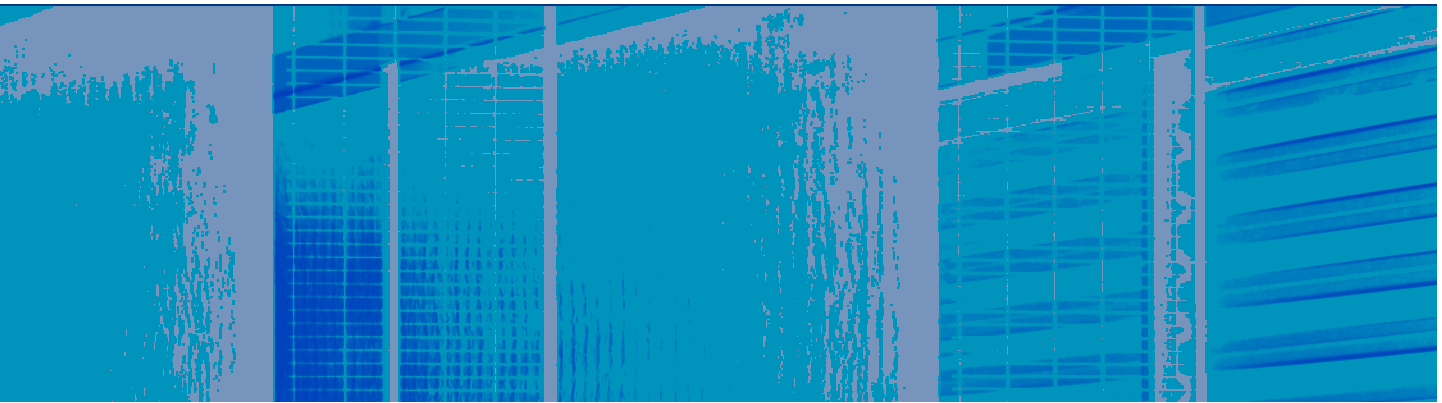

Move 20/2 is a stand-alone parking duplicator platform that makes it possible to park two cars and immediately withdraw them, without any hindrance or constraints, and in a completely independent manner.

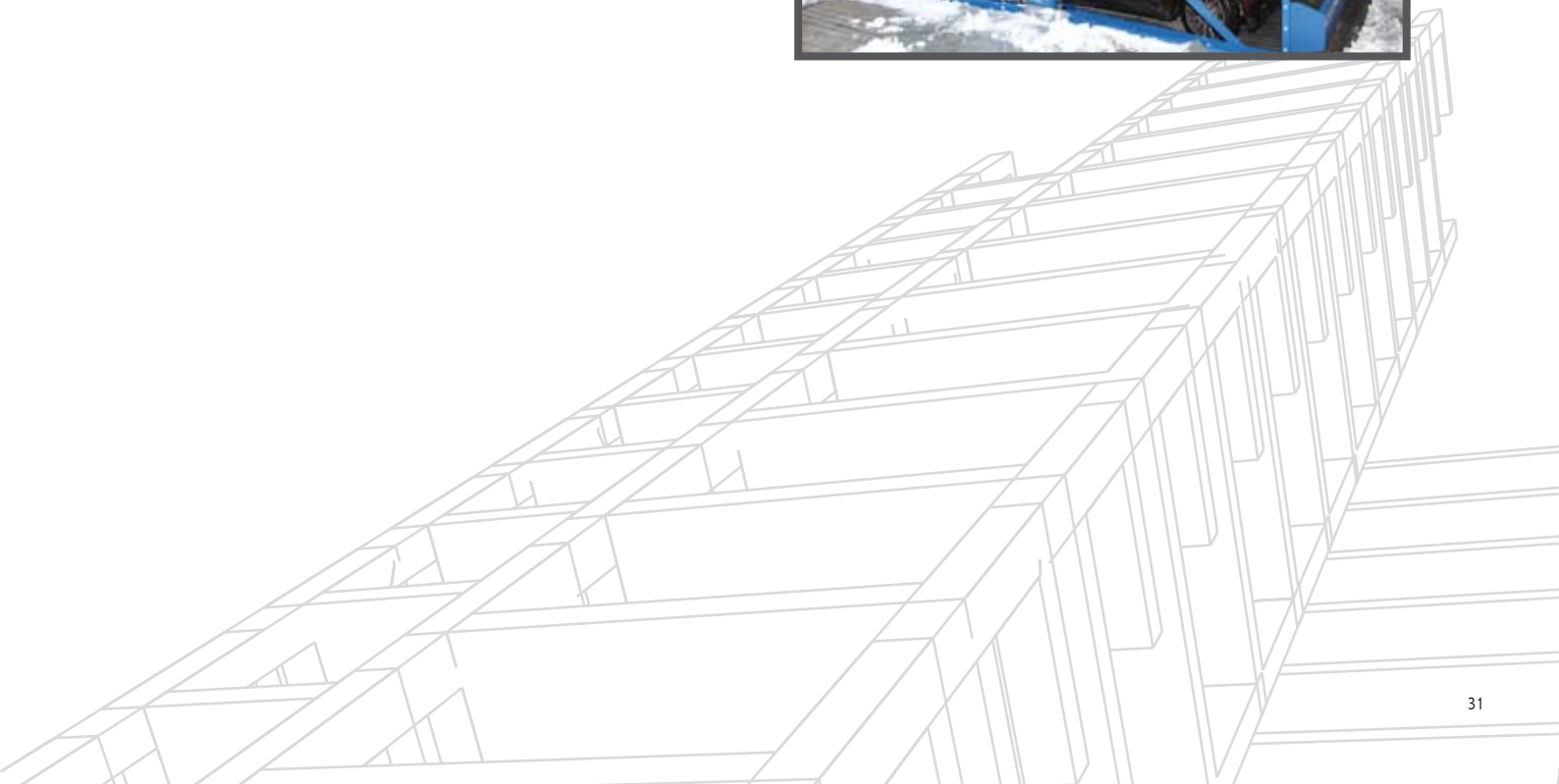

MOVE 20/2



The sequence of photographs clearly shows how the cars are managed and how practical this parking system is.



Like the Move 20 + 20/2, Move 20/2 has a hydraulically operated mechanical block at the top of the column able to ensure platform safety at all times.

The piston that locks the platform is controlled by a limit switch (installed also on the Move 20+20/2). This safety system checks whether the piston is completely inside/outside

its seat (functioning properly); if this is not the case, the platform will be automatically blocked.





The sequence of photographs shows how the mechanical locking piston on the floor of the platform sets the unit in safety mode.



The piston exits the column to engage the shoulder and block the unit. As soon as this operation is completed, the oil is discharged out of the en-



tire hydraulic system; thus the circuit does not need to remain pressurized and this, in turn, reduces wear and increases the life of the unit.



The column slide shoulder is solidly secured to the platform and the outside of the piston shaft, allowing it to function. The sturdiness of this product is its foremost index of quality and machine safety.



The columns are secured to the wall with brackets and chemical anchors. This operation ensures the utmost stability.

SECTION

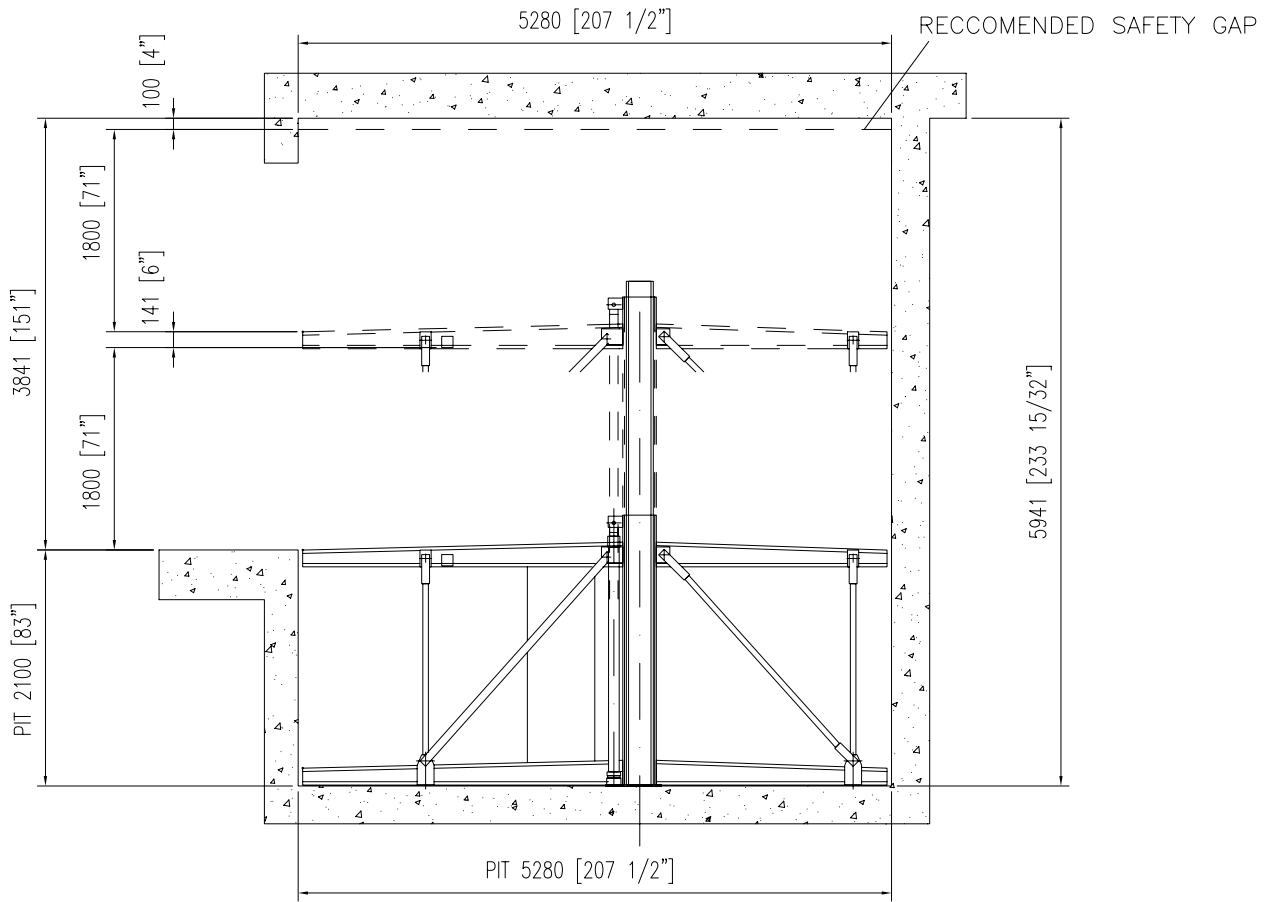

PLANT

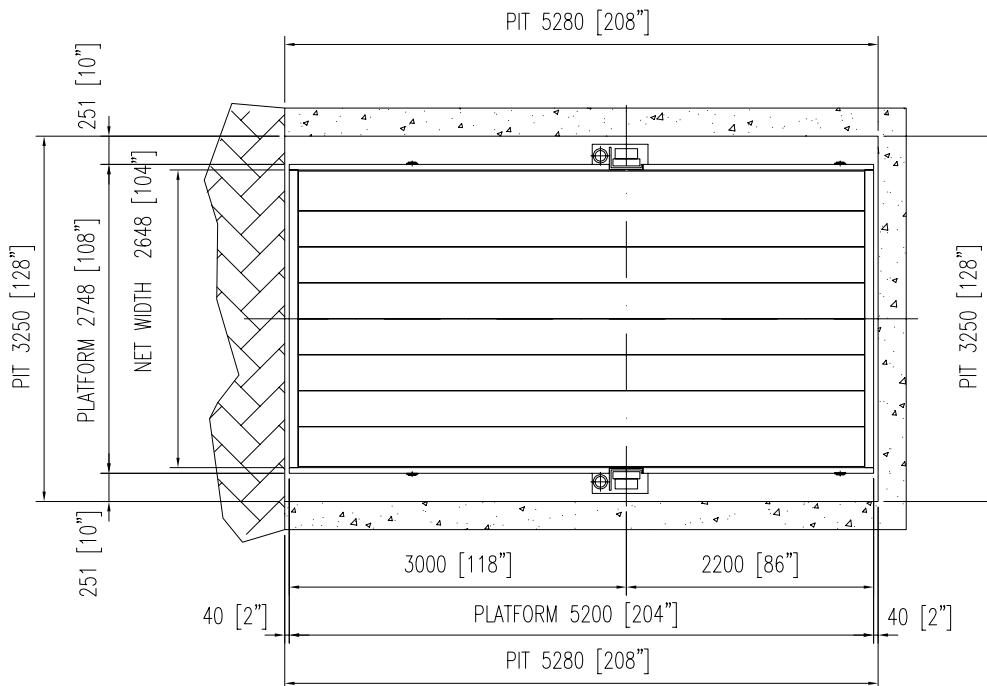

TECHNICAL DATA SHEET AND ACCESSORIES

	Capacity	Standard Lifting Height	Max Lifting Height	Minimum Platform	Standard Platform	Max Platform	Net height	Pit	Power	Speed	Power supply	Standard Weight	Notes
MOVE 20/2	2X2.000 kg.	1.941 mm	2.100 mm	2.200x4.500 mm	2.750 x 5200 mm	3.000x6.000 mm	1.800 mm	2.100 mm	4 kw	0,03 m/s	400 v / 50 hz	3.500 kg.	
	2x4.410 lbs	76,4 inch	82,7 inch	86,5x177,2 inch	108,2x204,7 inch	118x236,2 inch	70,9 inch	82,7 inch	5,4 hp	1,2 inch/s	400 v / 50 hz	7709 lbs	

ACCESSORIES

■ STANDARD ITEM □ OPTIONAL ITEM

DESCRIPTION	MOVE 20/2	NOTES
Standard colours: BLU / BLUE RAL 5005 e/and ARGENTO / SILVER RAL 9006	■	
Nr. 2 columns complete with lifting cylinders	■	
Nr. 2 platform in galvanised plate	■	
Nr. 1 torsion bar	■	
Nr. 1 "dead man" push-button board	■	
Security control module for sensors and safety locks	■	
Nr. 1 hydraulic control unit with motor	■	
Power Supply: 400-460V/3Ph/50-60Hz	■	
Nr. 1 deceleration kit	■	
Standard height H=1.800mm.	■	
N. 4 stop wheels bars L=745 mm	■	
N° 8 stop wheels bars L=1700 mm		
Level locking mechanical devices	■	
Mechanical and electrical safety devices	■	
Nylon Package	■	
Additional push button board	□	
Additional electro - magnetic sensor	□	
Safety lock for concertina and standard doors	□	
Torsion bar in two pieces	□	
Flashing light	□	
Audible warning kit	□	
Two-colours tower light (Red / Green)	□	
Energy Saving Soft Start	□	
Emergency manual pump	□	
Back-up battery	□	
Waterproof galvanised cover for control unit for outdoor installation	□	
Waterproof push-button board IP 65	□	
Car Presence Sensor	□	
Non standard colour*	□	
Nr. 1 fixed handrail protection without grid H=1200 mm.(each meter)*	□	
Hot Galvanisation	□	Columns, guides, tie rods, profiles runways, cross braces

MOVE 20+20/2



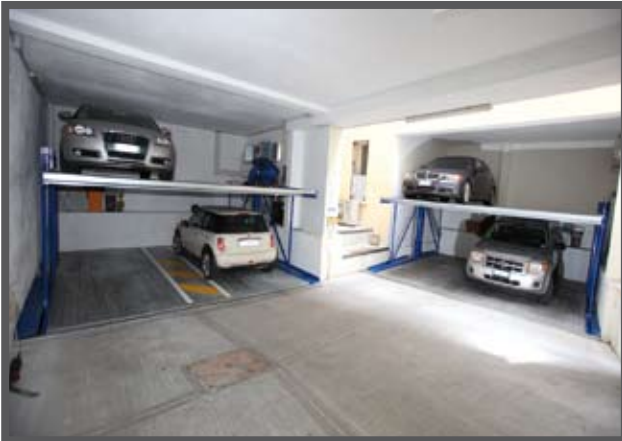
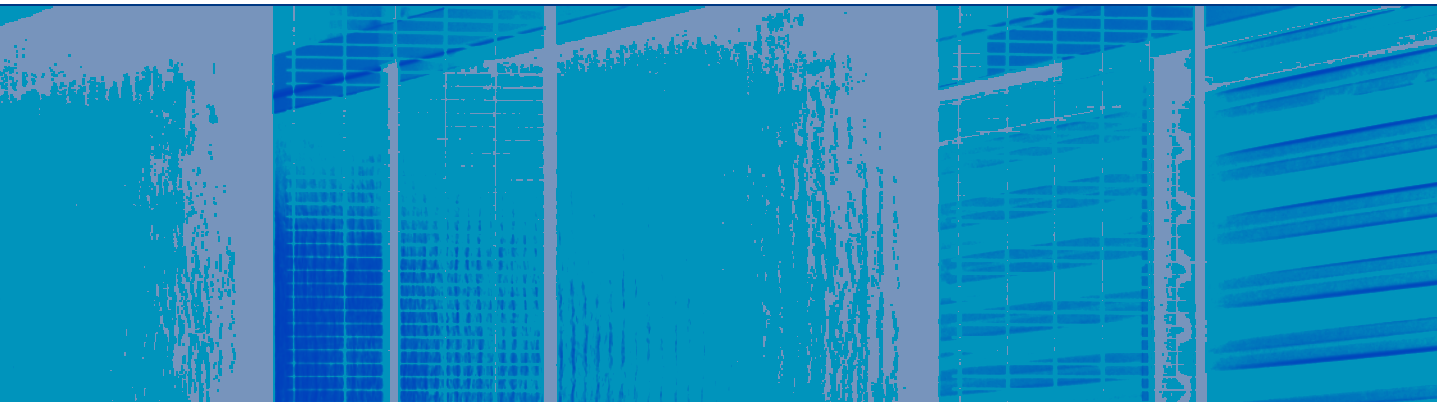

The Move 20 + 20/2 is a stand-alone duplicator platform. A series of technical innovations make it one of the highest qualities, safest platforms available worldwide for this market sector.

This product can also be used in particular situations such as asymmetrical positioning of even just two cars on different platforms.





Operating phase one



Operating phase two

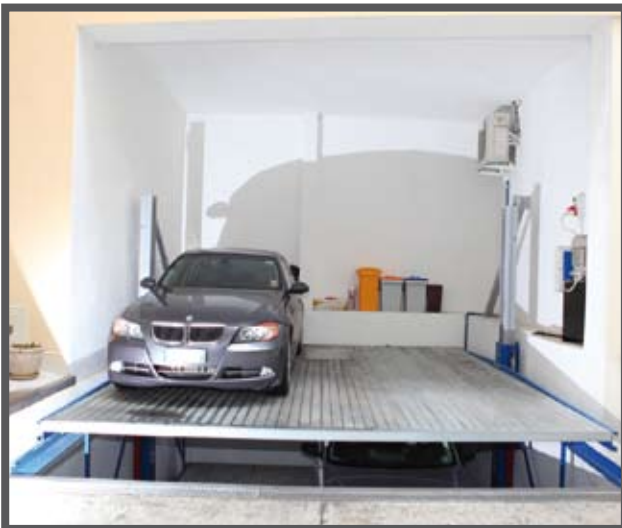

Operating phase three



Operating phase four



As seen in the pictures, the platform functions perfectly, even when the loads are out of balance as clearly seen above.

The photo of the structures connecting the platforms - both upper and lower - show its sturdy frame that guarantees safety. The galvanization finish is applied on both the top and underside of the platform, thus increasing quality and product life.

The surfaces of the platforms are perfectly smooth and so compact that no liquids can drip down from the overlying part.



The structure is repeated on the lower part of the underlying platform, thus ensuring that entire unit is sturdy.

The direct-operation lift piston is positioned to the side of the column, maintaining structural integrity without any holes which would weaken the structure.



The column is fixed to the wall with perforated L-shaped steel brackets that guarantee the utmost stability and safety.



The shoulder connected to the platform is fixed to the upper end of the piston shaft which allows it to slide along the column.

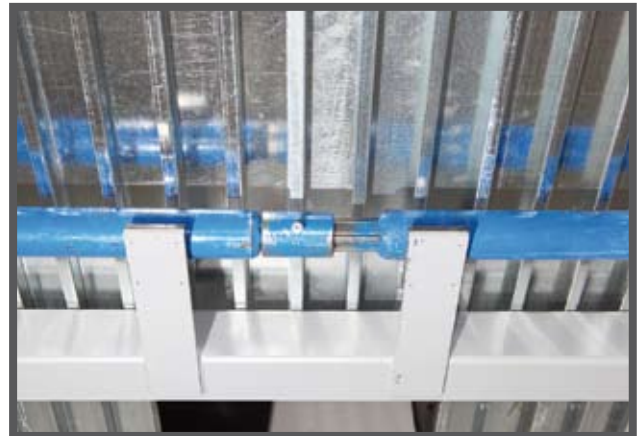

The photo shows the intermediate joint on the torsion bar.

The lower platform has a hatch to access to the lower level for controls and maintenance.

The access is set in the center of the platform so that it is accessible even when vehicles are parked.

The torsion bar is composed of two sections secured in the center by a mechanical joint.

The torsion bar system makes balancing the weight on the platforms unnecessary, distributing any uneven weight along the entire torsion bar and enabling the two pistons to work symmetrically so they cannot be thrown out of balance.



The hatch leading to the lower platform while open.





The unit has a system that mechanically blocks the platform floor, ensuring platform remains safely at the set level; it cuts in when the hydraulically operated piston emerges from the column.



The piston emerging from the column enters a special opening on the guide shoulder.

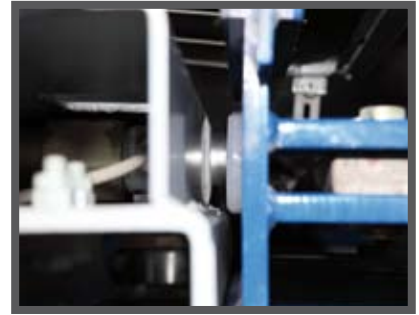

When the piston enters this opening, the shoulder — which had surpassed the piston itself by a few centimeters to facilitate insertion — drops down once more so that it rests on the opening.

At this point the entire hydraulic system can depressurise since the platform is mechanically locked at the level.



The machine operating assembly is quite compact and takes up little space and yet it still provides easy access for controls and maintenance.



The pushbutton control panel has an up button, a down button, a mushroom-shaped emergency button and activation keys. Moreover, the panel is supplied with illustration of the operations required to manage unit function.

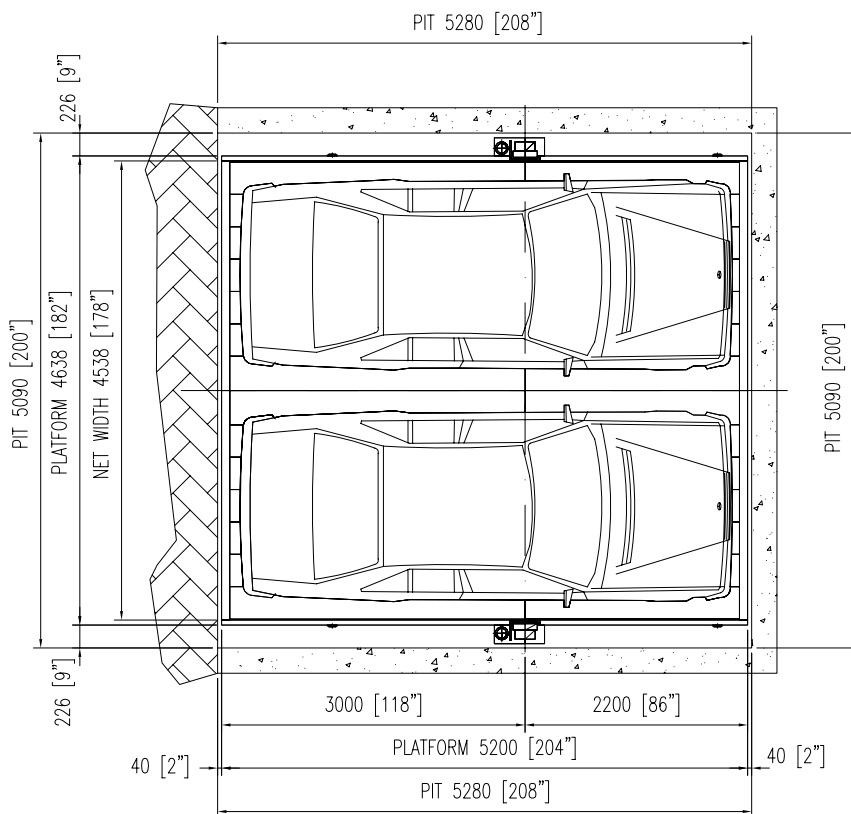
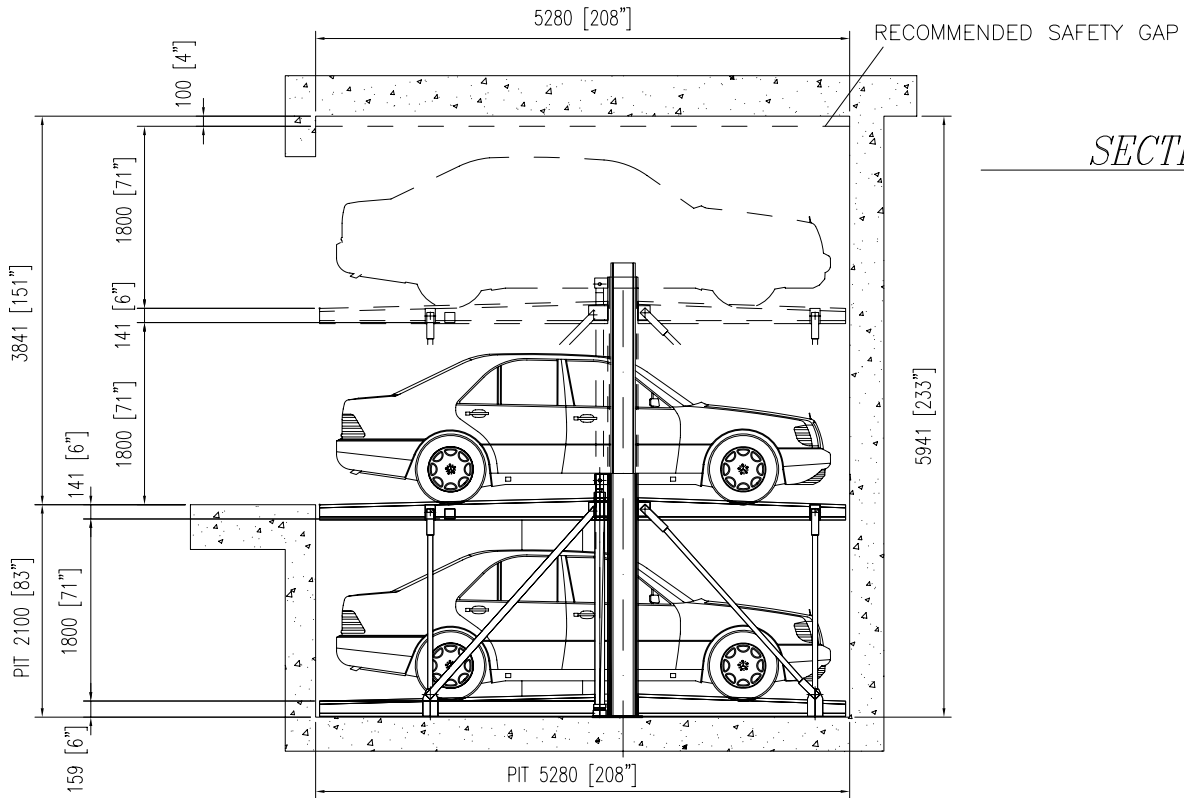

TECHNICAL DATA SHEET AND ACCESSORIES

	Capacity	Standard Lifting Height	Max Lifting Height	Minimum Platform	Standard Platform	Max Platform	Net height	Pit	Power	Speed	Power supply	Standard Weight	Notes
MOVE 20+ 20/2	2X2.000 + 2X2.000 kg.	1.941 mm	2.100 mm	3.000x4.500 mm	4.640 x 5.200 mm	4.640x6.000 mm	1.800 mm	2.100 mm	7,5 kw	0,03 m/s	400 v / 50 hz	4.700 kg.	
	2x4.410 + 2x4.410 lbs	76,4 inch	82,7 inch	118,1x177,2 inch	182,6x204,7 inch	118,1x236,2 inch	70,9 inch	82,7 inch	10,2 hp	1,2 inch/s	400 v / 50 hz	10.352 lbs	

ACCESSORIES

■ STANDARD ITEM □ OPTIONAL ITEM

DESCRIPTION	MOVE 20 + 20/2	NOTES
Standard colours: BLU / BLUE RAL 5005 e/and ARGENTO / SILVER RAL 9006	■	
Nr. 2 columns complete with lifting cylinders	■	
Nr. 2 platform in galvanised plate	■	
Nr. 1 torsion bar	■	
Nr. 1 "dead man" push-button board	■	
Security control module for sensors and safety locks	■	
Nr. 1 hydraulic control unit with motor	■	
Power Supply: 400-460V/3Ph/50-60Hz		
Nr. 1 deceleration kit	■	
Standard height H=1.800mm.	■	
N. 4 stop wheels bars L=745 mm	■	
N° 8 stop wheels bars L=1700 mm		
Level locking mechanical devices	■	
Mechanical and electrical safety devices	■	
Nylon Package	■	
Additional push button board	□	
Additional electro - magnetic sensor	□	
Safety lock for concertina and standard doors	□	
Torsion bar in two pieces	□	
Flashing light	□	
Audible warning kit	□	
Two-colours tower light (Red / Green)	□	
Energy Saving Soft Start	□	
Emergency manual pump	□	
Back-up battery	□	
Waterproof galvanised cover for control unit for outdoor installation	□	
Waterproof push-button board IP 65	□	
Car Presence Sensor	□	
Non standard colour*	□	
Nr. 1 fixed handrail protection without grid H=1200 mm.(each meter)*	□	
Hot Galvanisation	□	Columns, guides, tie rods, profiles runways, cross braces