

TECNOPARK





Tecnopark is an automated parking system that offers high intensity vehicle storage, making the most of differently shaped areas such as courtyards, obsolete garages or basements located in city centres.

This electro-hydraulic system uses hydraulics for vertical movement of the lift and electricity to for all horizontal movement of the parking platforms.

The vehicle is moved using metal platforms supported by plastic wheels that reduce noise and structural vibrations to the barest minimum.

This is extremely versatile, modular parking that is flexible and can be adapted to various urban areas.

This system allows you to choose the type of vertical lift - column (MOVE) or pantograph (REX) - and thus can be used in a wide range of situations. Where possible, installation of a turntable makes it possible to orient the vehicle so that it can easily be driven into and out of the parking space.

The user accesses parking by entering his vehicle parking or taking off code on the interactive "touch screen" panel; this screen also displays all information the system sends the user.

After the user has set the vehicle on the platform at the entrance, the system checks the geometries to ensure that all movement inside the parking area is interference-free and, if no problems are found, it automatically starts the movement cycle.

The high-tech control panel can be monitored remotely over a common telephone line.

Each cell has a code that can be called up by the user to identify his vehicle.

The parking lot can be outfit with a fire detection and extinguishing system.

Safety at all entrances to the parking zone is monitored to prevent anyone from entering the automatic vehicle movement areas.

Tecnopark comes with all documentation required by the Machine Directive and has CE marking in compliance with European standard EN 14010.

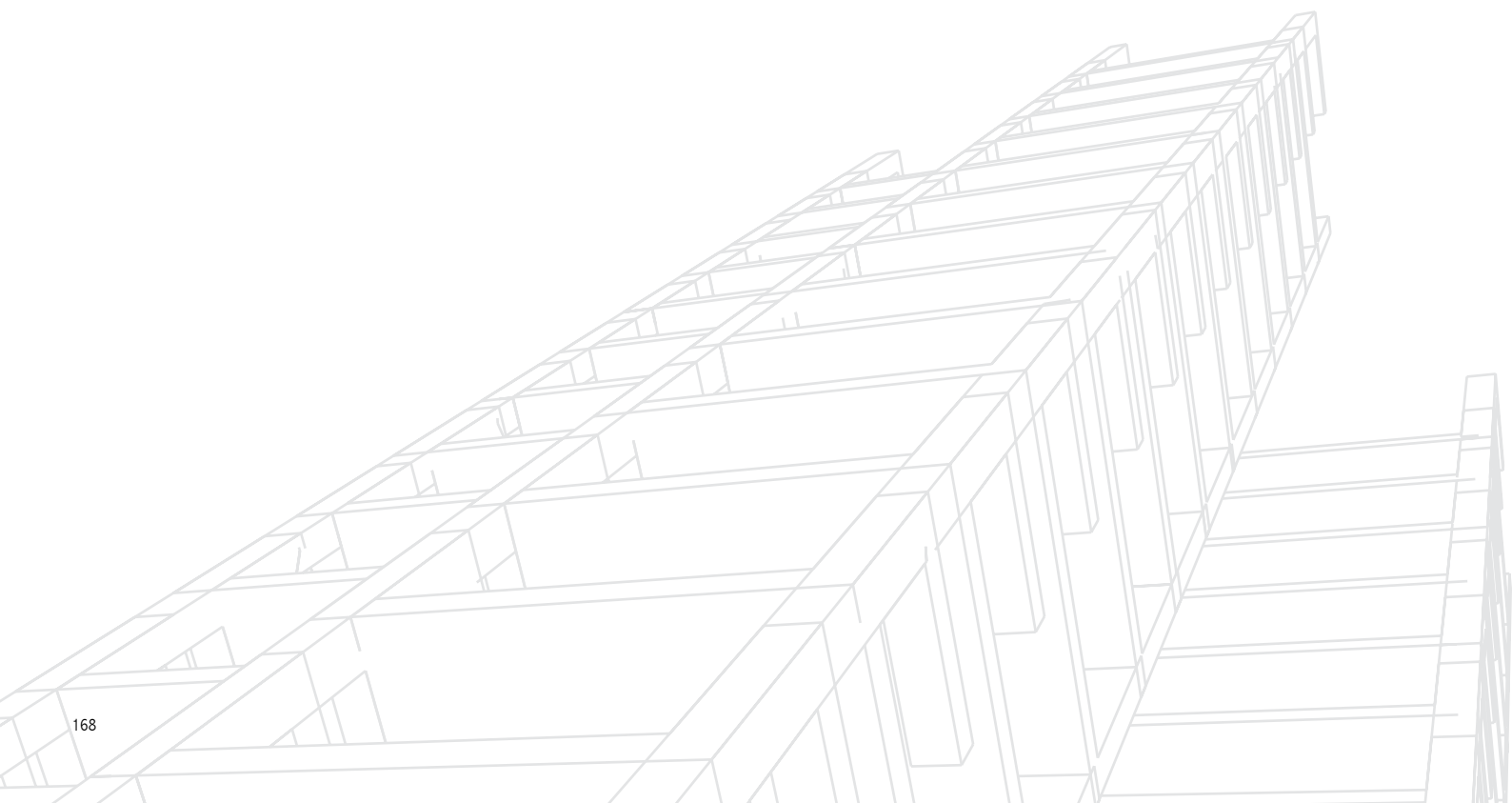

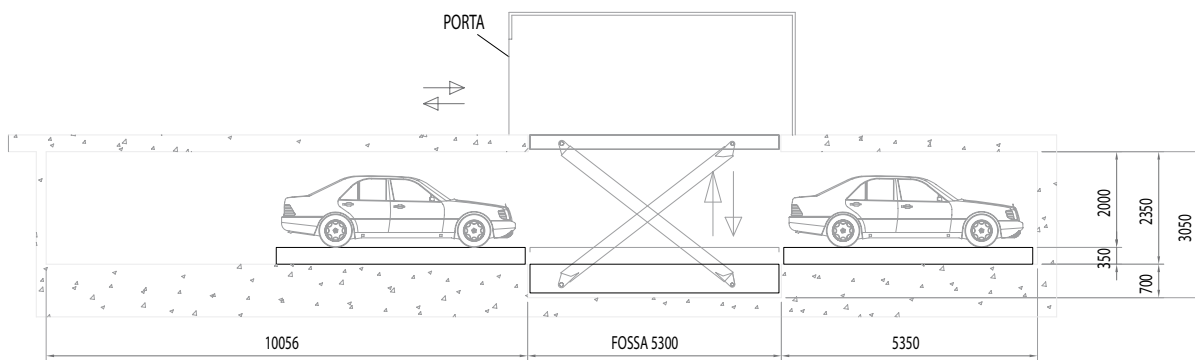

SEZIONE A-A

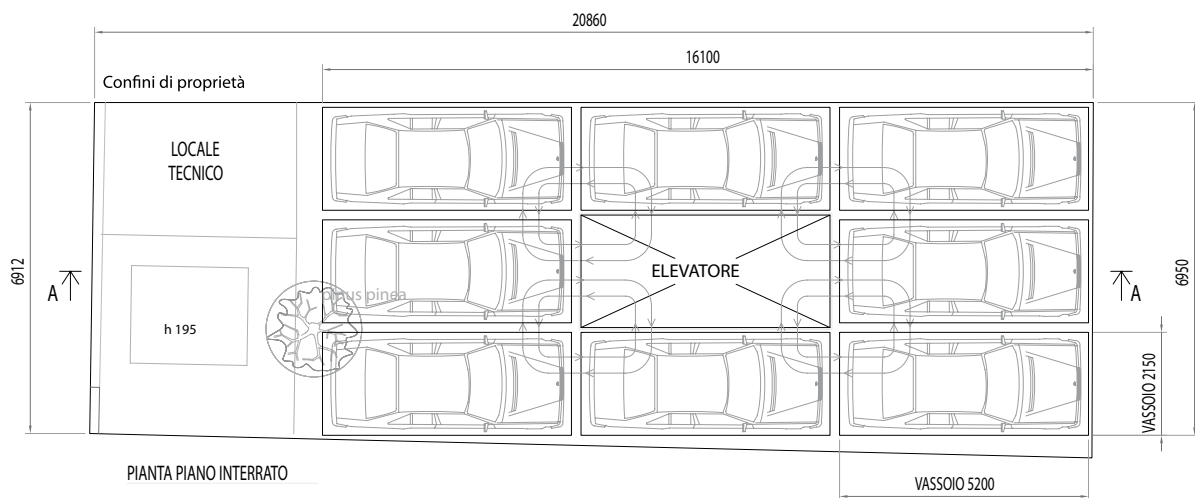

PIANTA PIANO INTERRATO

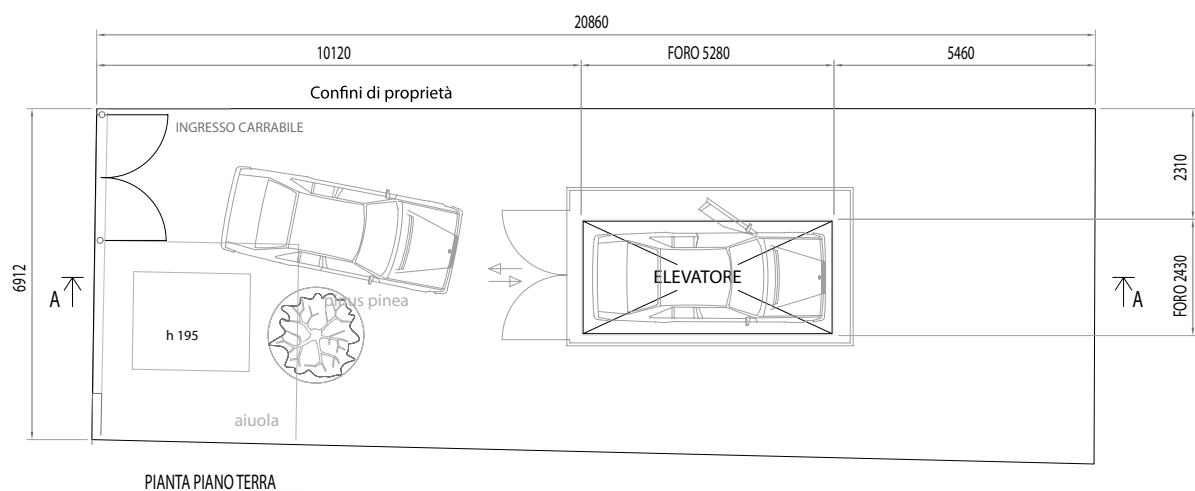

PIANTA PIANO TERRA

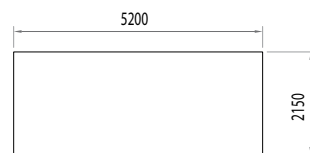

DIMENSIONI VASSOIO

LAYOUT 1064

The parking system is a superb solution that makes available 8 parking cells per floor and a central pantograph lift. The lift does not require vertical guides. Parking is extremely easy and the stepped movement of

the platforms containing the vehicles is quite rapid. The parking lot is accessed from a special above-ground zone where vehicle positioning is controlled.

SEZIONE A-A CORTEA-A

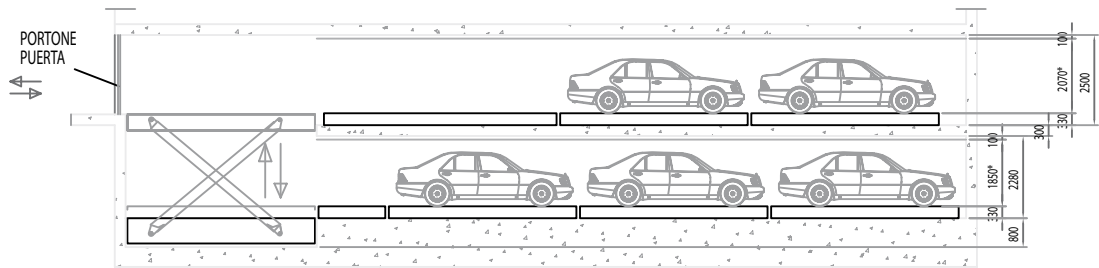

(*) = ALTEZZA AL NETTO DI IMPIANTO SPRINKLER

(*) = ALTO (SIN LA INSTALACIÓN SPRINKLER)

LIVELLI DA CONFERMARE

MEDIDAS DE AUTO A CONFIRMAR

PIANTA PIANO INTERRATO SOTANO

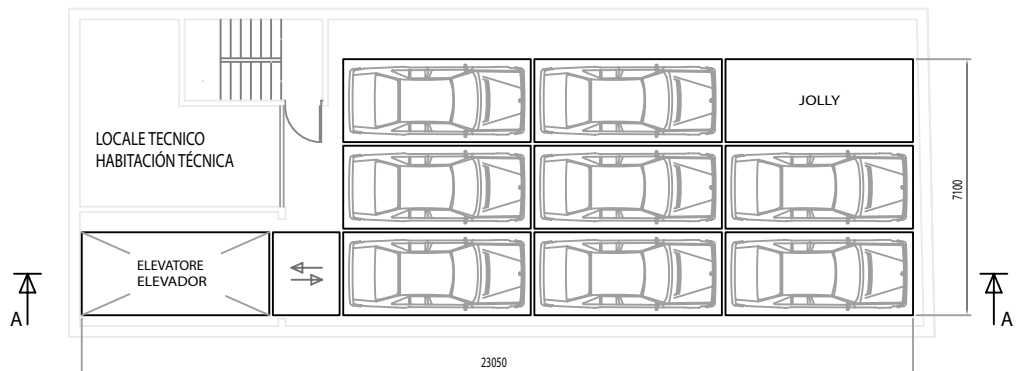

PIANTA PIANO INGRESSO PLANTA BAJA

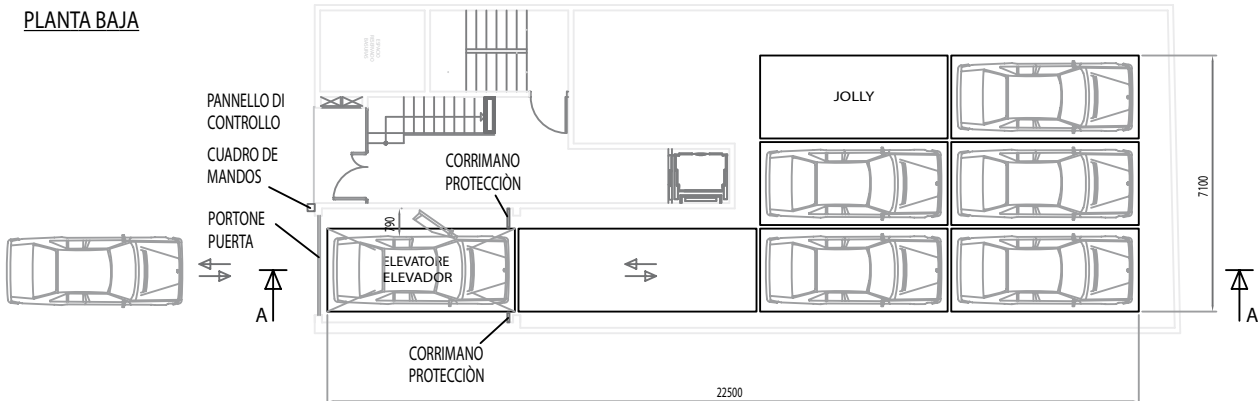

DIMENSIONE VASSOIO MEDIDAS PLATAFORMA



DA DEFINIRE POSIZIONE LOCALE TECNICO

(~4000x2500)

EN LA ESPERA DE QUE NOS COMUNIQUEN EL LUGAR PRECISO
DONDE TENEIS PENSADO COLOCAR LA HABITACION TÉCNICA (~4000X2500)

LAYOUT 1093

The parking lot is entered from the street level at the end of the building.

The platforms move horizontally, bringing the vehicle into the cell parking zone.

The pantograph lift does not require vertical guides.

The selected vehicle is moved from the parking zone to the pick-up zone with stepped movement.

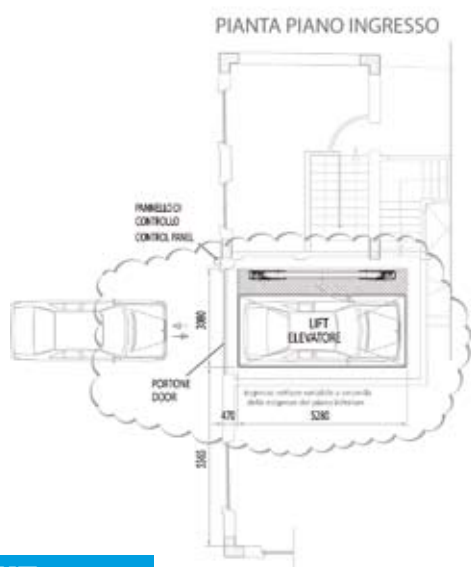

N.B. NEI DISEGNI CIVILI, L'INGRESSO AL PIANO TERRA È SFALATO IN VERTICALE RISPETTO AI PIANI INTERRATI

LAYOUT 1097

The parking lot is entered from the street level at the end of the building. The platforms move horizontally, bringing the vehicle into the cell parking zone. The vertical guide lift moves the vehicle to the parking floors.

The selected vehicle is moved from the parking zone to the pick-up zone with stepped movement of the platform. Using an empty central lane speeds up movement of the vehicles to the lift.

SEZIONE A-A

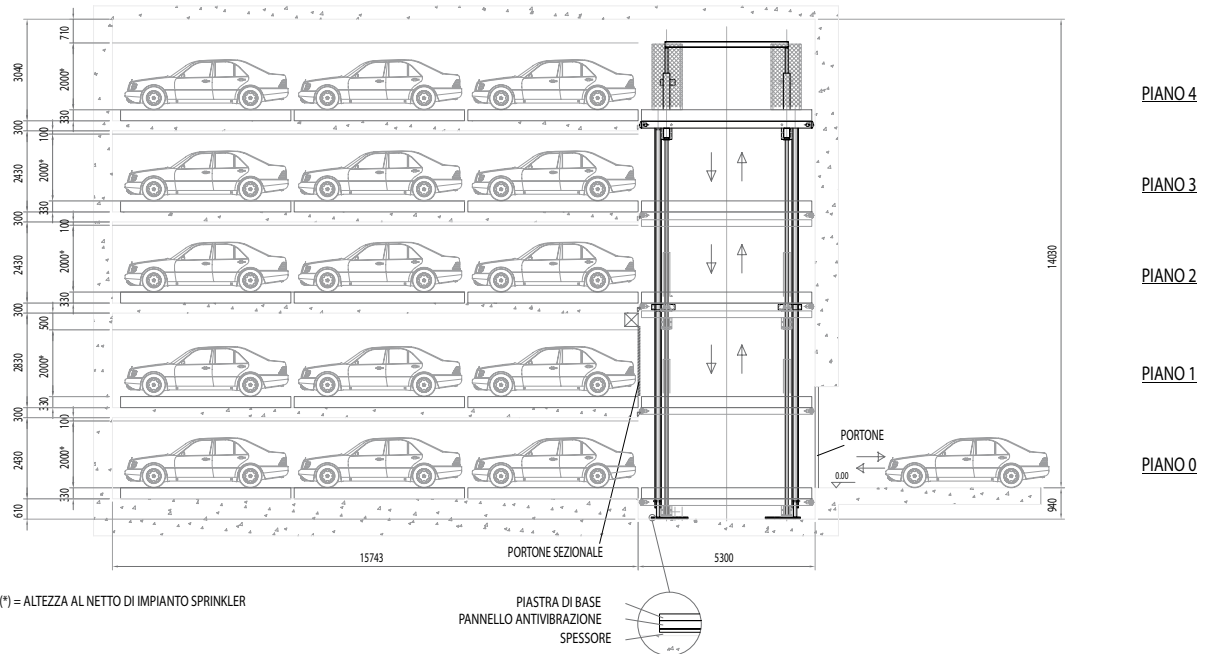

PIANTA PIANO TERRA

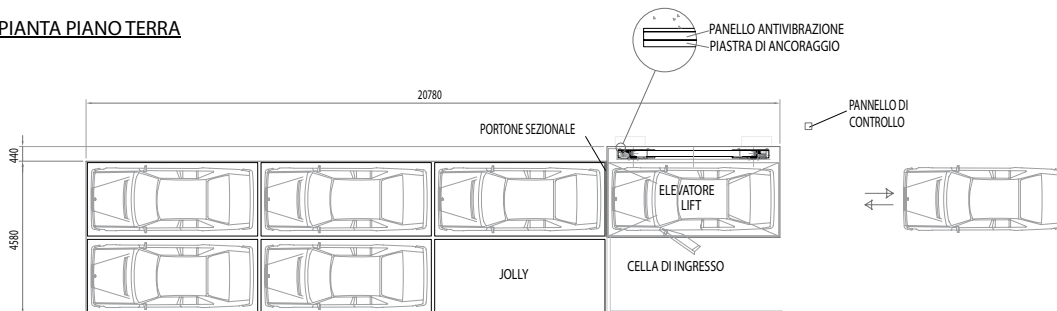

LAYOUT 1101

This is a multi-floor parking lot that is extremely compact and makes the most of a pre-existing facility, remodeled for automatic parking. Entrance is at street level, in a special area set aside for positioning the vehicles before they are automatically moved. At the entrance, the vehicle pla-

form is moved onto the lift with stepped movement passing between the various parking cells.

The vertical guide lift moves the vehicle to the various parking floors, mechanically hooking onto the desired floor.

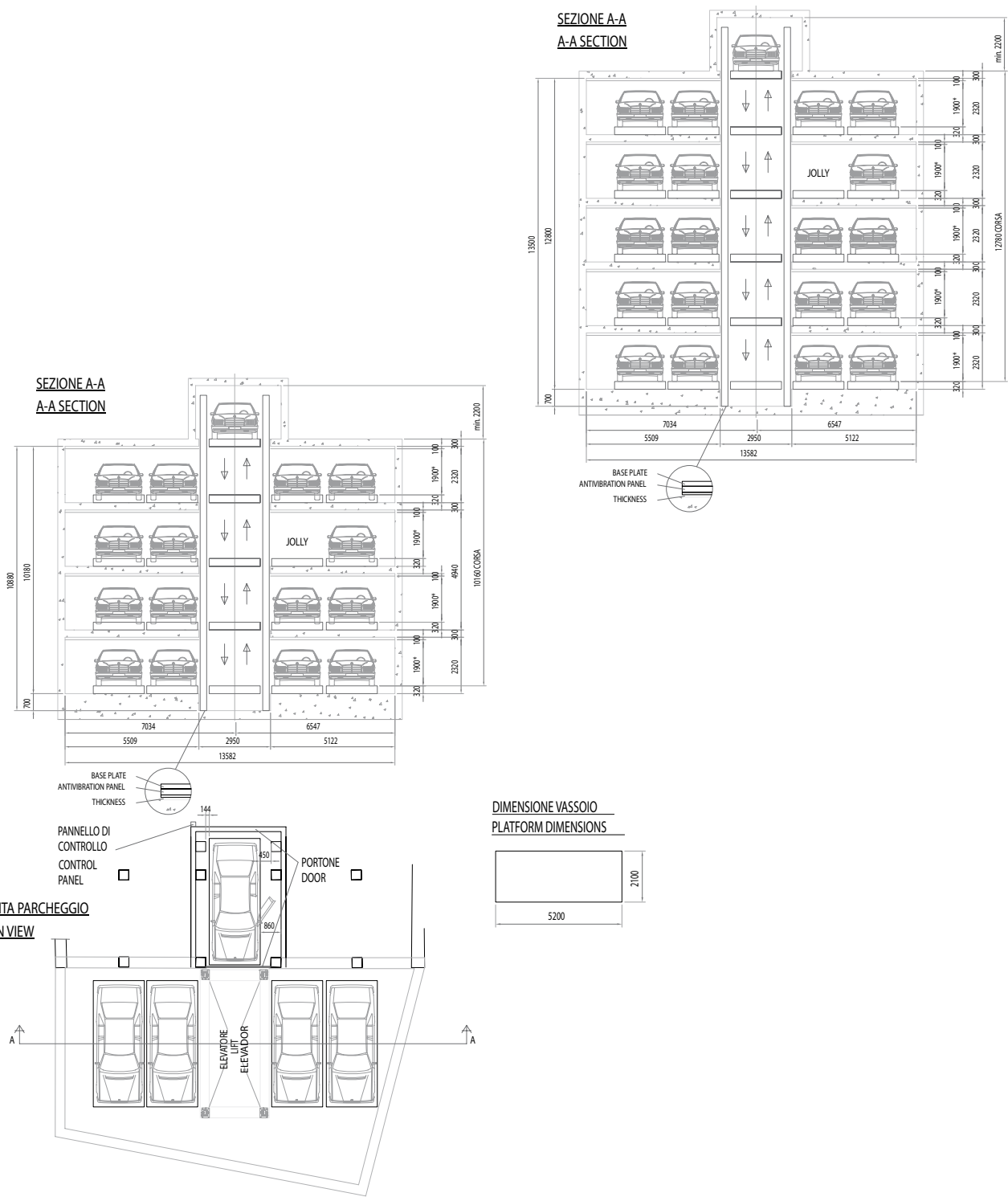

LAYOUT 1103

An extremely compact, multi-floor parking lot that makes the most of a vertical section of the building for automatic parking. Entrance is at the ground floor, in a special area set aside for positioning the vehicle before it is automatically moved.

The vehicles in the front rows are moved quite rapidly while those in the back rows are moved using the empty or jolly cell. The vertical lift with four guides moves the vehicle to the various parking floors, mechanically hooking onto the desired floor.

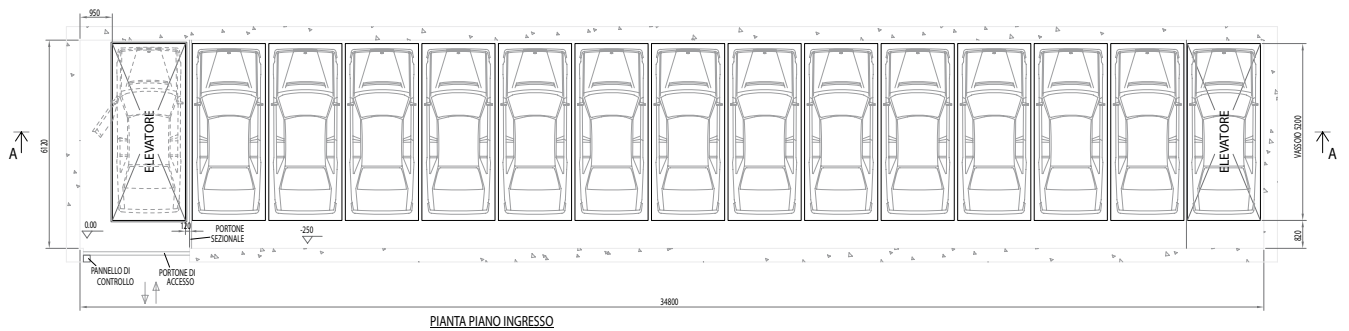
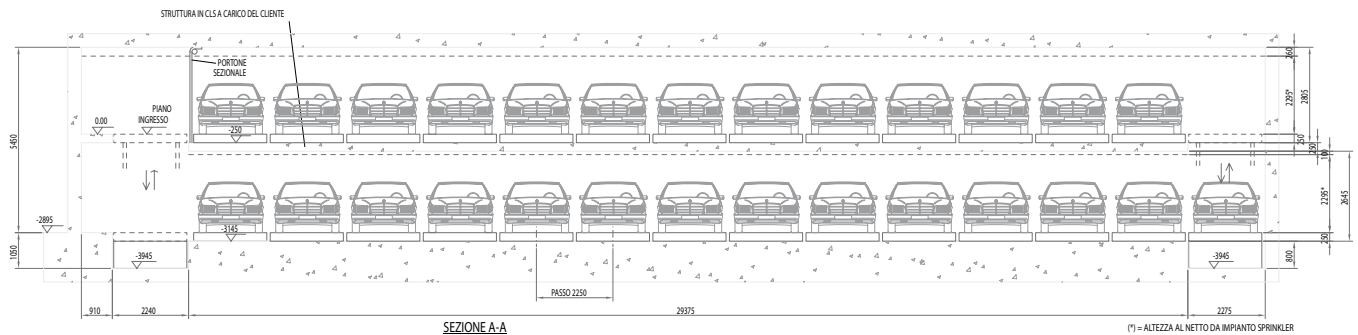

LAYOUT 1069

This type of parking facility uses rooms that are long but narrow. The platforms with vehicles are transferred to the various floors by stepped movement of the two lifts at the ends of the room. Entrance is on the ground floor, in a

special vehicle positioning area arranged at one or both ends of the parking lot. The two pantograph lifts do not require vertical guides.

PIANTA PARCHEGGIO
PLAN VIEW

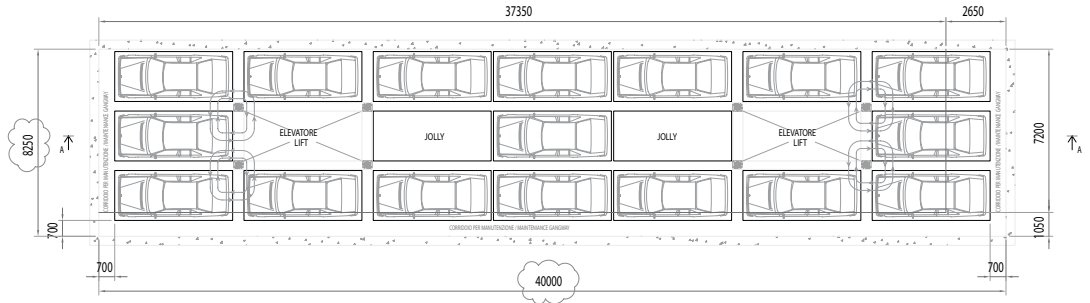

SEZIONE A-A
A-A SECTION

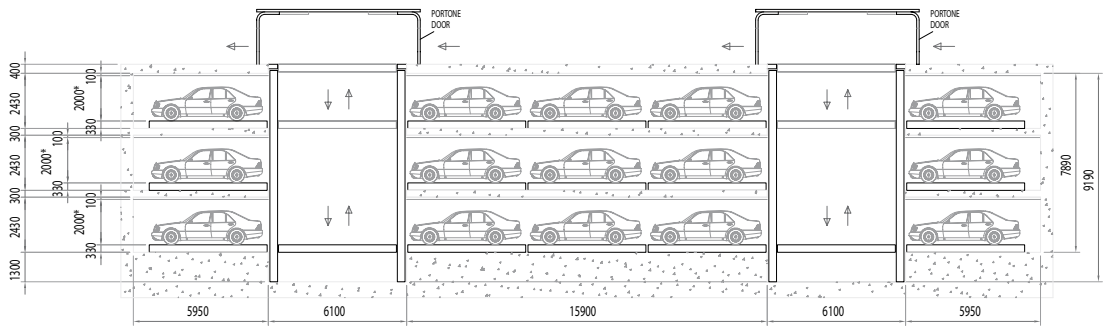

(*) = ALTEZZA AL NETTO DI IMPIANTO SPRINKLER
 (*) = NET HEIGHT (WITHOUT SPRINKLER)

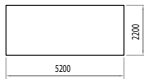

DIMENSIONE VASSOIO
PLATFORM DIMENSIONS

LAYOUT 1083

This high-intensity parking lot uses two entrances/exits to speed up operations. The central parking area can be served by both entrances.

The lifts have four vertical guides, arranged so that the load-bearing platform and guides do not protrude above street level.



Fig 1:
Vehicle entrance to control positioning on platform. Entrance is protected from the vehicle storage zone by two sectional doors.



Fig 2:
Area beside the entrance where the vehicle platforms are stored.



Fig 3:
Area beside the entrance where the vehicle platforms are stored showing the sectional door closed.





Fig 4: View of the hydraulic lift control unit complete with protection casing and control panel with interface for monitoring, alarms and maintenance of the systems.



Fig 5: Detail of the operator panel used to provide information and to enter the access codes for parking and picking up vehicles.

